

**02 - 08.3**  
04.18.GB

**Shut-off valves UV 926**  
**Check valves ZV 926**



# UV/ZV 926



## Shut-off and check valves DN 10 - 65 PN 63, 100, 160, 250, 320, 400, 630

### Description

Shut-off valves UV 926 are single-seated globe valves designed for shutting off flow of a media. The valves could be optionally equipped with shaped plug for rough control in case of demand. Shut-off valves UV 926 according to ČSN EN 13709. The valve seat surface is made with hard metal overlay due to increased service life. The conical shape of the seat in combination with the spherical shape of the plug ensures a high tightness of the closure. The valves are delivered with weld ends or can be delivered in flanged execution if required.

### Application

- power generation
- chemical processing industries

Maximal permissible pressure and temperature see pg. 7 and 8.

### Process Media

- water
- steam
- other liquids and gases which are compatible with materials of the valve body and internal materials

### Installation

The valves with hand wheel can be installed in any position. The valve with electric actuator can be installed in any position except position when the actuator is under the valve body. It is necessary to ensure enough of space for handling. The flow direction is arbitrary except execution with control plug. In case of control plug the flow direction has to be under the plug. It is suitable to insulate the pipeline around the valve but it is prohibited to insulate the valve yoke.

Check valves ZV926 AUT (without spring) can be installed in a horizontal position blinder up only.

Check valves ZV926 AUP (with spring) can be installed in any position.

The flow direction must agree with arrow on the valve body.

It is necessary to ensure enough of space for handling and maintenance.

### Technical data

Series	UV926		ZV926
Execution	Shut-off valve (optionally with control plug)		Check valve
Nominal size	DN 10 - 65		
Nominal pressure	PN 63, 100, 160, 250, 320, 400, 630		
Seat material	Body mat. + hard metal overlay Stellite 6		
Plug material	1.4923 + hard metal overlay Real 096		
Yoke material	1.0619	1.7357	---
Weld ends connection	Acc. to ČSN EN 12627, ČSN 131075		
Flange ends connection	Acc. to ČSN EN 1092-1		
Available types of flanges	Type B1 (raised-face flange); type B2 (plain flange), type C (tongue flange); type D (flange with groove); type E (male flange); type F (female flange)		
Flow characteristic	On-Off; control		On-Off
Leakage rate	Class A (On-Off characteristic) acc. to ČSN EN 12266-1 (11/2003)		
	Class D (Control characteristic) acc. to ČSN EN 12266-1 (11/2003)		---
Packing	Graphite		

Body material	Operating temperature (from -10°C)
11416	to 400°C
12020	to 350°C
1.0460	to 450°C
15128	to 575°C
1.4571	to 600°C
1.4903	to 600°C
1.5415	to 550°C
1.7335	to 550°C
1.7380	to 600°C
1.7383	to 600°C

Body material	Operating temperature (from -10°C)
1.4541	to 600°C
1.4901	to 650°C
A182 F92	to 650°C
A182 F22	to 600°C
A182 F316	to 650°C

## Dimensions and weights of UV 926 with weld ends

DN	H	L <sub>1</sub>	V <sub>1</sub>	V <sub>2</sub>	V <sub>3</sub>	D <sub>4,max</sub>	K	D <sub>5</sub>	D <sub>6</sub>	D <sub>7</sub>	D <sub>8</sub>	a <sub>p</sub>	n <sub>p</sub>	d <sub>p</sub>	m <sub>1</sub>
	mm	mm	mm	mm	mm	mm	mm	mm	mm	mm	mm	mm		mm	kg
10	12	150	33	266	225	36	200	125	102	70	20	14	8	12	5.8
15															10
20	16	160	47	298	250	54	250	175	140	100	30	18	8	18	21
25															37
32	22	210	66	387	319	70	400	175	140	100	30	18	8	18	21
40															37
50	36	250	85	480	401	90	500	175	140	100	30	18	8	18	37
65															37

m<sub>1</sub> - approximate weight with weld ends

Dimensions of weld ends according to ČSN EN 12627 (ČSN 131075), or by customer request.

Flanged connection optionally if required.

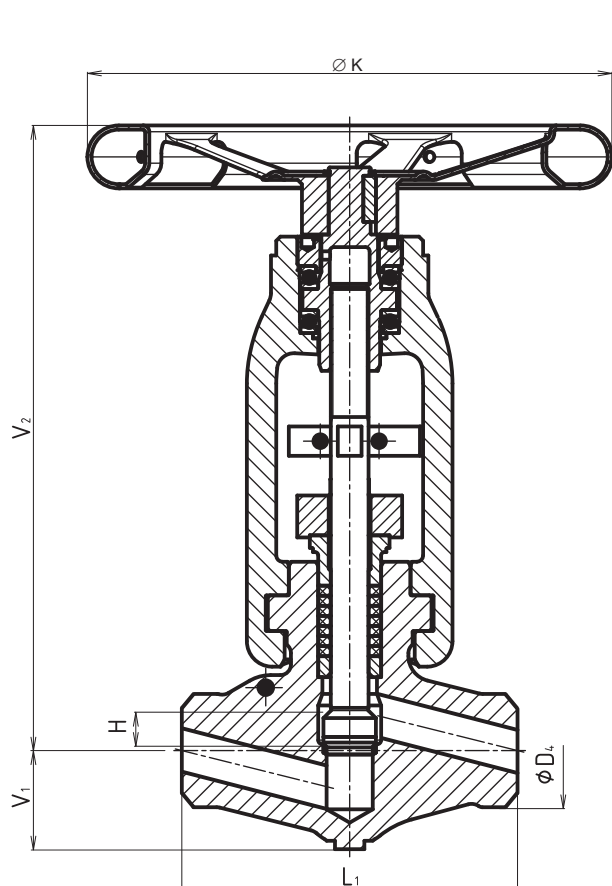

Weld ends execution with hand wheel

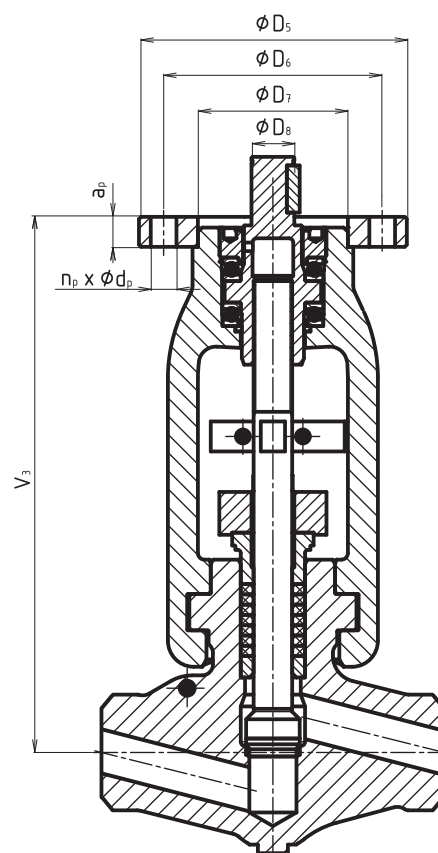

Weld ends execution with adjustment for electric actuator

## Dimensions and weights of ZV 926 with weld ends

DN	L	V	V <sub>1</sub>	D <sub>4,max</sub>	m <sub>1</sub>
	mm	mm	mm	mm	kg
10	150	82	33	36	2
15					
20	160	98	47	54	4
25					
32	210	128	66	70	9
40					
50	250	154	85	90	15
65					

m<sub>1</sub> - approximate weight with weld ends

Dimensions of weld ends according to ČSN EN 12627 (ČSN 131075), or by customer request.

Flanged connection optionally if required.

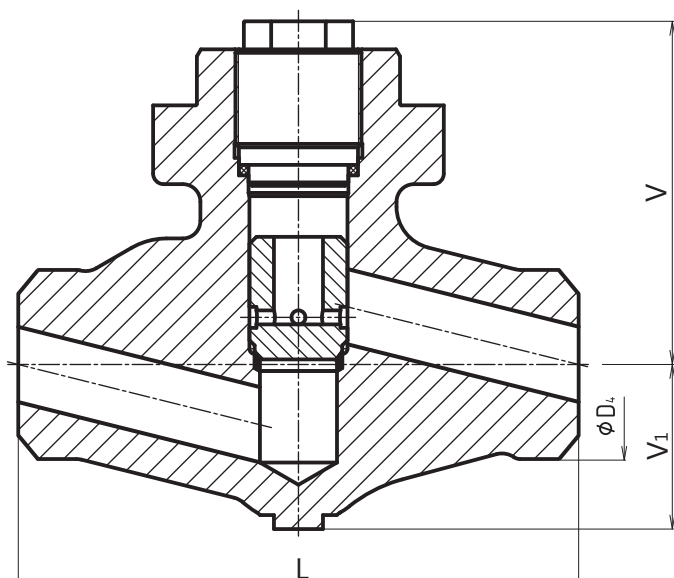

Welded execution without spring

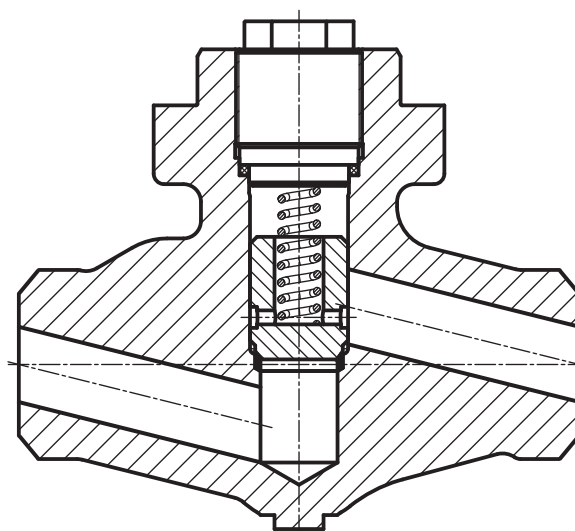

Welded execution with spring

## Valve complete specification No. for ordering UV/ZV 926

		XX	XXX	XXX	XXXX	XX	XXX	/	XXX	-	XXX
1. Valve	Shut-off valve	UV									
	Check valve	ZV									
2. Series			926								
3. Type of actuating	Electric actuator			EXX							
	Hand wheel			RXX							
	Without spring			AUT							
	With spring			AUP							
4. Connection	Flanges with raised faces, type B1				1						
	Female flange, type F				2						
	Flanges with plain faces, type B2				3						
	Welded				4						
	Male flange, type E				5						
	Tongue flange, type C				6						
	Flange with groove, type D				7						
	Other				9						
5. Body material	Material 11416 (-10 to 400°C)				A						
	Material 12020 (-10 to 350°C)				B						
	Material 15128 (-10 to 575°C)				C						
	Material 1.0460 (-10 to 450°C)				D						
	Material 1.4571 (-10 to 600°C)				E						
	Material 1.4903 (-10 to 600°C)				F						
	Material 1.5415 (-10 to 550°C)				G						
	Material 1.7335 (-10 to 550°C)				H						
	Material 1.7380 (-10 to 600°C)				I						
	Material 1.7383 (-10 to 600°C)				J						
	Material 1.4541 (-10 to 600°C)				K						
	Material 1.4901 (-10 to 650°C)				L						
	Material A182 F92 (-10 to 650°C)				M						
	Material A182 F22 (-10 to 600°C)				N						
Material A182 F316 (-10 to 650°C)				O							
Other				9							
6. Packing	Graphite				5						
7. Execution	Standard				0						
8. Plug type	Shut-off					0					
	Control					1					
9. Accessories	Without					0					
10. Nominal pressure	PN 63						063				
	PN 100						100				
	PN 160						160				
	PN 250						250				
	PN 320						320				
	PN 400						400				
	PN 630						630				
	Operating parameters							PS-			
11. Operating temperature °C	Acc. to operating conditions							/	XXX		
12. Nominal diameter	DN									-	XXX

### Ordering code example:

UV926 R25 4B50 00 063/350-020, weld ends acc. to EN 12627-2-DN20, pipe size 26,9 x 2,3

## Data for an actuator specification

The valves are designed to be actuated with multi-turn electric actuators of the following producers: Auma, Schiebel, ZPA Pečky or others. Actuator connection corresponds ČSN EN ISO 5210, see dimensional sketch on the pg. 3 on this data sheet.

Valves are adjusted with actuators so that in the closed position, i.e. when closing to the seat, the torque switch turns off. In the open position they are adjusted so that the position switch turns off (the torque switch for open position is adjusted as a safety switch to protect the valve against a damage only). Connecting flange of actuator is designed to allow rotation of the drive of 45°.

## Assigning actuator to valve

DN	Stroke [mm]	RPM / stroke [n]	Max. torque		Connection acc. to ČSN EN ISO 5210
			max. PN250 [Nm]	PN320 and more [Nm]	
10 - 15	12	6	20	25	F10 / typ B3
20 - 25	16	8	40	55	F10 / typ B3
32 - 40	22	7,3	80	110	F14 / typ B3
50 - 65	36	6	180	250	F14 / typ B3

## Recommended values of output speed (rpm)

DN	Shut-off valve (running time 10 - 20 sec.)	Shut-off valve with control plug (running time 40 - 60 sec.)
	[n/min.]	[n/min.]
10 - 15	18 - 36	6 - 9
20 - 25	24 - 48	8 - 12
32 - 40	22 - 44	7,5 - 11
50 - 65	18 - 36	6 - 9

## Actuator marking in valve specification No.

Electric actuator Auma SA 07.2	E A A	Electric actuator SIPOS 2SA50	E T B
Electric actuator Auma SAEx 07.2	E A B	Electric actuator SIPOS 2SA55	E T C
Electric actuator Auma SAR 07.2	E A C	Electric actuator SIPOS 2SA58 HiMod	E T C
Electric actuator Auma SAREx 07.2	E A D	Electric actuator Modact MON/MOP	E Y E
Electric actuator Auma SA 07.6	E A E	Electric actuator Modact MON/MOP Control	E Y F
Electric actuator Auma SAEx 07.6	E A F	Electric actuator Modact MONED/MOPED	E Y F
Electric actuator Auma SAR 07.6	E A G	Electric actuator Modact MONJ	E Y E
Electric actuator Auma SAREx 07.6	E A H	Electric actuator Modact MONJ Control	E Y F
Electric actuator Auma SA 10.2	E A I	Electric actuator Modact MONEDJ	E Y F
Electric actuator Auma SAEx 10.2	E A L	Hand wheel for DN 10 - 15	R 2 0
Electric actuator Auma SAR 10.2	E A J	Hand wheel for DN 20 - 25	R 2 5
Electric actuator Auma SAREx 10.2	E A K	Hand wheel for DN 32 - 40	R 4 0
Electric actuator Auma SA(R,Ex) 14.2	E A M	Hand wheel for DN 50 - 65	R 5 0
Electric actuator Schiebel Ab3	E Z A	Without spring	A U T
Electric actuator Schiebel exAB3	E Z B	With spring	A U P
Electric actuator Schiebel rAB3	E Z C		
Electric actuator Schiebel exrAB3	E Z D		
Electric actuator Schiebel Ab5	E Z E		
Electric actuator Schiebel exAB5	E Z F		
Electric actuator Schiebel rAB5	E Z G		
Electric actuator Schiebel exrAB5	E Z H		
Electric actuator Schiebel Ab8	E Z I		
Electric actuator Schiebel exAB8	E Z J		
Electric actuator Schiebel rAB8	E Z K		
Electric actuator Schiebel exrAB8	E Z L		

## Maximal permissible pressure values [Mpa]

Material	PN	Temperature [ °C ]													
		100	150	200	250	300	350	400	450	500	550	575	600	625	650
Cast steel 11416	63	6.3	6.3	6.3	5.55	4.82	4.13	3.58	---	---	---	---	---	---	---
	100	10.0	10.0	10.0	8.81	7.65	6.55	5.68	---	---	---	---	---	---	---
	160	16.0	16.0	16.0	14.1	12.2	10.5	9.09	---	---	---	---	---	---	---
	250	25.0	25.0	25.0	22.0	19.1	16.4	14.2	---	---	---	---	---	---	---
	320	---	---	---	---	---	---	---	---	---	---	---	---	---	---
	400	40.0	40.0	40.0	35.2	30.6	26.2	22.7	---	---	---	---	---	---	---
	630	63.0	63.0	63.0	55.5	48.2	41.3	35.8	---	---	---	---	---	---	---
Cast steel 12020	63	6.3	5.82	5.51	5.04	4.56	4.09	---	---	---	---	---	---	---	---
	100	10.0	9.25	8.75	8.0	7.25	6.5	---	---	---	---	---	---	---	---
	160	16.0	14.8	14.0	12.8	11.6	10.4	---	---	---	---	---	---	---	---
	250	25.0	20.5	19.4	17.7	16.1	14.4	---	---	---	---	---	---	---	---
	320	---	---	---	---	---	---	---	---	---	---	---	---	---	---
	400	---	---	---	---	---	---	---	---	---	---	---	---	---	---
	630	---	---	---	---	---	---	---	---	---	---	---	---	---	---
Alloy steel 15128	63	6.3	6.3	6.3	6.3	6.3	6.3	6.3	6.3	6.3	3.91	2.47	---	---	---
	100	10.0	10.0	10.0	10.0	10.0	10.0	10.0	10.0	10.0	6.2	3.91	---	---	---
	160	16.0	16.0	16.0	16.0	16.0	16.0	16.0	16.0	16.0	9.92	6.26	---	---	---
	250	25.0	25.0	25.0	25.0	25.0	25.0	25.0	25.0	25.0	15.5	9.78	---	---	---
	320	---	---	---	---	---	---	---	---	---	---	---	---	---	---
	400	40.0	40.0	40.0	40.0	40.0	40.0	40.0	40.0	40.0	24.8	15.7	---	---	---
	630	63.0	63.0	63.0	63.0	63.0	63.0	63.0	63.0	63.0	39.1	24.7	---	---	---
Cast steel 1.0460 C22.8, P250GH	63	5.85	5.55	5.25	4.8	4.35	4.05	3.75	2.07	---	---	---	---	---	---
	100	9.28	8.8	8.33	7.61	6.9	6.42	5.95	3.28	---	---	---	---	---	---
	160	14.85	14.09	13.33	12.19	11.04	10.28	9.52	5.25	---	---	---	---	---	---
	250	23.21	22.02	20.83	19.04	17.26	16.07	14.88	8.21	---	---	---	---	---	---
	320	29.71	28.19	26.66	24.38	22.09	20.57	19.04	10.51	---	---	---	---	---	---
	400	37.14	35.23	33.33	30.47	27.61	25.71	23.8	13.14	---	---	---	---	---	---
	630	58.5	55.5	52.5	48.0	43.5	40.5	37.5	20.7	---	---	---	---	---	---
Stainless steel 1.4571 X6CrNiMoTi17-12-2	63	6.3	6.09	5.64	5.38	5.12	4.85	4.59	4.41	4.15	3.67	3.39	2.45	---	---
	100	10.0	9.66	8.96	8.54	8.12	7.7	7.28	7.0	6.58	5.82	5.39	3.89	---	---
	160	16.0	15.46	14.34	13.67	13.0	12.33	11.65	11.21	10.53	9.32	8.62	6.23	---	---
	250	25.0	24.16	22.41	21.36	20.31	19.26	18.21	17.51	16.45	14.56	13.47	9.74	---	---
	320	32.0	30.93	28.68	27.34	26.0	24.65	23.31	22.41	21.07	18.64	17.25	12.46	---	---
	400	40.0	38.65	35.85	34.17	32.49	30.81	29.13	28.01	26.33	23.29	21.55	15.58	---	---
	630	63.0	60.9	56.4	53.8	51.2	48.5	45.9	44.1	41.5	36.7	33.9	24.5	---	---
Stainless steel 1.4903 X10CrMoVNb9-1	63	6.3	6.3	6.3	6.3	6.3	5.91	5.38	4.97	4.15	3.67	3.52	3.15	---	---
	100	10.0	10.0	10.0	10.0	10.0	9.38	8.53	7.89	6.58	5.82	5.59	5.0	---	---
	160	16.0	16.0	16.0	16.0	16.0	15.02	13.66	12.62	10.53	9.32	8.94	8.0	---	---
	250	25.0	25.0	25.0	25.0	25.0	23.47	21.34	19.72	16.45	14.56	13.97	12.5	---	---
	320	32.0	32.0	32.0	32.0	32.0	30.04	27.32	25.25	21.07	18.64	17.88	16.01	---	---
	400	40.0	40.0	40.0	40.0	40.0	37.55	34.14	31.56	26.33	23.29	22.35	20.01	---	---
	630	63.0	63.0	63.0	63.0	63.0	59.1	53.8	49.7	41.5	36.7	35.2	31.5	---	---
Alloy steel 1.5415 15Mo3, 16Mo3	63	6.3	6.16	5.75	5.37	4.99	4.69	4.54	4.2	2.86	1.01	---	---	---	---
	100	10.0	9.78	9.12	8.52	7.92	7.44	7.2	6.67	4.53	1.6	---	---	---	---
	160	16.0	15.66	14.6	13.64	12.68	11.91	11.53	10.68	7.26	2.56	---	---	---	---
	250	25.0	24.46	22.81	21.31	19.81	18.61	18.01	16.68	11.34	4.0	---	---	---	---
	320	32.0	31.31	29.2	27.28	25.36	23.82	23.05	21.36	14.51	5.12	---	---	---	---
	400	40.0	39.13	36.49	34.09	31.69	29.77	28.81	26.7	18.14	6.4	---	---	---	---
	630	63.0	61.6	57.5	53.7	49.9	46.9	45.4	42.0	28.6	10.1	---	---	---	---
Alloy steel 1.7335 13CrMo4-5	63	6.3	6.3	6.3	6.3	6.3	5.87	5.38	4.97	3.93	1.85	---	---	---	---
	100	10.0	10.0	10.0	10.0	10.0	9.31	8.53	7.89	6.24	2.93	---	---	---	---
	160	16.0	16.0	16.0	16.0	16.0	14.91	13.66	12.62	9.99	4.7	---	---	---	---
	250	25.0	25.0	25.0	25.0	25.0	23.29	21.34	19.72	15.6	7.34	---	---	---	---
	320	32.0	32.0	32.0	32.0	32.0	29.81	27.32	25.25	19.98	9.39	---	---	---	---
	400	40.0	40.0	40.0	40.0	40.0	37.26	34.14	31.56	24.97	11.74	---	---	---	---
	630	63.0	63.0	63.0	63.0	63.0	58.7	53.8	49.7	39.3	18.5	---	---	---	---

## Maximal permissible pressure values [Mpa]

Material	PN	Temperature [ °C ]													
		100	150	200	250	300	350	400	450	500	550	575	600	625	650
Alloy steel 1.7380 10CrMo9-10	63	6.3	6.3	6.3	6.3	6.3	5.91	5.38	4.97	4.15	2.22	2.17	0.94	---	---
	100	10.0	10.0	10.0	10.0	10.0	9.38	8.53	7.89	6.58	3.52	3.44	1.49	---	---
	160	16.0	16.0	16.0	16.0	16.0	15.02	13.66	12.62	10.53	5.63	5.51	2.39	---	---
	250	25.0	25.0	25.0	25.0	25.0	23.47	21.34	19.72	16.45	8.8	8.6	3.73	---	---
	320	32.0	32.0	32.0	32.0	32.0	30.04	27.32	25.25	21.07	11.27	11.01	4.78	---	---
	400	40.0	40.0	40.0	40.0	40.0	37.55	34.14	31.56	26.33	14.09	13.76	5.98	---	---
1.7383 11CrMo9-10	630	63.0	63.0	63.0	63.0	63.0	59.1	53.8	49.7	41.5	22.2	21.7	9.4	---	---
	63	5.82	5.47	5.12	4.85	4.59	4.41	4.23	4.06	3.88	3.36	3.28	2.89	---	---
	100	9.24	8.68	8.12	7.7	7.28	7.0	6.72	6.44	6.16	5.33	5.2	4.59	---	---
	160	14.79	13.89	13.0	12.33	11.65	11.21	10.76	10.31	9.86	8.54	8.32	7.34	---	---
	250	23.11	21.71	20.31	19.26	18.21	17.51	16.8	16.1	15.4	13.34	13.0	11.47	---	---
	320	29.58	27.79	26.0	24.65	23.31	22.41	21.51	20.62	19.72	17.07	16.65	14.68	---	---
Stainless steel 1.4541 X6CrNiTi18-10	400	36.97	34.73	32.49	30.81	29.13	28.01	26.89	25.77	24.65	21.34	20.81	18.35	---	---
	630	58.2	54.7	51.2	48.5	45.9	44.1	42.3	40.6	38.8	33.6	32.8	28.9	---	---
	63	6.3	6.3	6.3	6.3	6.3	6.16	5.72	5.29	4.59	4.25	4.14	3.79	3.43	2.73
	100	10.0	10.0	10.0	10.0	10.0	9.78	9.08	8.4	7.29	6.75	6.58	6.01	5.45	4.34
	160	16.0	16.0	16.0	16.0	16.0	15.65	14.53	13.45	11.66	10.79	10.52	9.62	8.72	6.94
	250	25.0	25.0	25.0	25.0	25.0	24.45	22.71	21.01	18.23	16.87	16.44	15.03	13.62	10.84
Steel 1.4901 X10CrWMoVNb9-2 A182 F92	320	32.0	32.0	32.0	32.0	32.0	31.29	29.07	26.89	23.33	21.59	21.05	19.24	17.43	13.88
	400	40.0	40.0	40.0	40.0	40.0	39.12	36.34	33.61	29.16	26.98	26.31	24.04	21.79	17.35
	630	63.0	63.0	63.0	63.0	63.0	61.6	57.2	52.9	45.9	42.5	41.4	37.9	34.3	27.3
	63	6.3	6.3	6.3	6.08	5.62	5.28	4.8	4.44	3.7	2.05	1.38	0.9	---	---
	100	10.0	10.0	10.0	9.65	8.92	8.38	7.62	7.04	5.87	3.26	2.19	1.43	---	---
	160	16.0	16.0	16.0	15.44	14.28	13.41	12.19	11.27	9.4	5.21	3.51	2.3	---	---
Alloy steel A182 F22	250	25.0	25.0	25.0	24.12	22.31	20.95	19.04	17.6	14.69	8.14	5.48	3.59	---	---
	320	32.0	32.0	32.0	30.88	28.56	26.82	24.38	22.54	18.8	10.42	7.02	4.59	---	---
	400	40.0	40.0	40.0	38.6	35.7	33.51	30.47	28.17	23.5	13.03	8.77	5.74	---	---
	630	63.0	63.0	63.0	60.8	56.2	52.8	48.0	44.4	37.0	20.5	13.8	9.0	---	---
	63	5.54	5.05	4.68	4.38	4.15	3.98	3.86	3.79	3.7	3.27	3.14	2.61	2.08	1.66
	100	8.79	8.02	7.43	6.95	6.59	6.32	6.13	6.01	5.87	5.2	4.99	4.15	3.29	2.64
Stainless steel A182 F316	160	14.06	12.83	11.89	11.12	10.54	10.11	9.81	9.62	9.4	8.32	7.98	6.64	5.27	4.22
	250	21.97	20.05	18.57	17.38	16.47	15.79	15.33	15.02	14.69	12.99	12.47	10.37	8.24	6.59
	320	28.13	25.67	23.78	22.25	21.08	20.22	19.63	19.23	18.8	16.63	15.96	13.27	10.54	8.44
	400	35.16	32.08	29.71	27.81	26.35	25.27	24.53	24.04	23.5	20.79	19.95	16.59	13.18	10.55
	630	55.4	50.5	46.8	43.8	41.5	39.8	38.6	37.9	37.0	32.7	31.4	26.1	20.8	16.6





LDM, spol. s r.o.  
Litomyšlská 1378  
560 02 Česká Třebová  
Czech Republic

tel.: +420 465 502 511  
fax: +420 465 533 101  
E-mail: sale@ldm.cz  
<http://www.ldm.cz>

LDM, spol. s r.o.  
Office in Prague  
Podolská 50  
147 01 Praha 4

tel.: 241087360  
fax: 241087192  
E-mail: tomas.suchanek@ldm.cz

LDM, spol. s r.o.  
Office in Ústí nad Labem  
Ladova 2548/38  
400 11 Ústí nad Labem  
- Severní Terasa

tel.: 602708257  
E-mail: tomas.kriz@ldm.cz

LDM servis, spol. s r.o.  
Litomyšlská 1378  
560 02 Česká Třebová  
Czech Republic

tel.: +420 465 502 411-3  
fax: +420 465 531 010  
E-mail: servis@ldm.cz

LDM, Polska Sp. z o.o.  
ul. Bednorza 1  
40-384 Katowice  
Poland

tel.: +48 32 730 56 33  
fax: +48 32 730 52 33  
mobile: +48 601 354 999  
E-mail: ldmpolska@ldm.cz

LDM Bratislava s.r.o.  
Mierová 151  
821 05 Bratislava  
Slovakia

tel.: +421 2 43415027-8  
fax: +421 2 43415029  
E-mail: ldm@ldm.sk  
<http://www.ldm.sk>

LDM - Bulgaria - OOD  
z. k. Mladost 1  
bl. 42, floor 12, app. 57  
1784 Sofia  
Bulgaria

tel.: +359 2 9746311  
fax: +359 2 9746311  
mobile: +359 888 925 766  
E-mail: ldm.bg@ldmvalves.com

OOO "LDM Promarmatura"  
Jubilejnyj prospekt,  
dom.6a, of. 601  
141400 Khimki Moscow Region  
Russian Federation

tel.: +7 4957772238  
fax: +7 4956662212  
mobile: +7 9032254333  
E-mail: inforus@ldmvalves.com

TOO "LDM"  
Shakirova 33/1  
kab. 103  
100012 Karaganda  
Kazakhstan

tel.: +7 7212 566 936  
fax: +7 7212 566 936  
mobile: +7 701 738 36 79  
E-mail: sale@ldm.kz  
<http://www.ldm.kz>

LDM Armaturen GmbH  
Wupperweg 21  
D-51789 Lindlar  
Germany

tel.: +49 2266 440333  
fax: +49 2266 440372  
mobile: +49 177 2960469  
E-mail: ldmmaturen@ldmvalves.com  
<http://www.ldmvalves.com>

Your partner